

# EATON VICKERS CAVITY TOOLS

## ROUGHERS - CARBIDE TIPPED

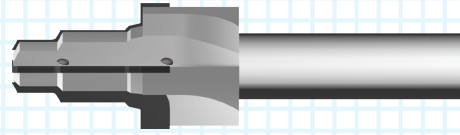
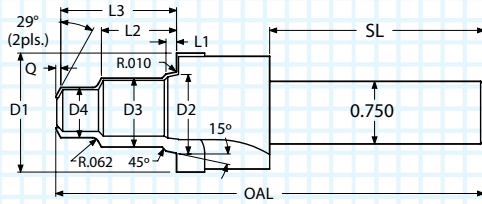

Coolant Hole(s) Each Flute

### TWO WAY CAVITY

D1	D2	D3	D4	L1	L2	L3	Q	OAL	SL	FLUTES	ORDER #		EDP #	
											UNCOATED	ALTiN+	UNCOATED	ALTiN+
1.163	0.789	0.663	0.476	0.108	0.750	1.188	0.050	4.00	2.00	3	C-8-2-ROUGH-X6	C-8-2-ROUGH-X6A	400397	400399
1.163	0.920	0.787	0.601	0.108	0.934	1.312	0.060	4.00	2.00	3	C-10-2-ROUGH-X6	C-10-2-ROUGH-X6A	400385	400387
1.475	1.124	0.950	0.913	0.138	1.375	1.825	0.075	5.25	2.25	4	C-12-2-ROUGH-X8	C-12-2-ROUGH-X8A	400324	400326
1.725	1.376	1.209	1.102	0.138	1.344	1.844	0.075	5.50	2.25	4	C-16-2-ROUGH-X8	C-16-2-ROUGH-X8A	400336	400338

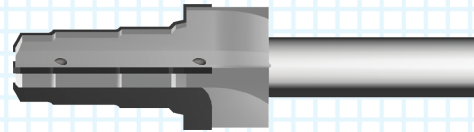
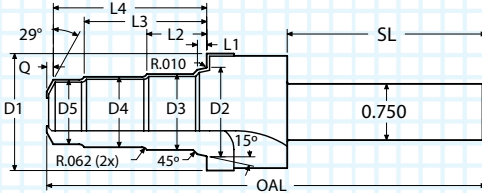

Coolant Hole(s) Each Flute

### THREE WAY CAVITY

D1	D2	D3	D4	D5	L1	L2	L3	L4	Q	OAL	SL	FLUTES	ORDER #		EDP #	
													UNCOATED	ALTiN+	UNCOATED	ALTiN+
1.163	0.789	0.663	0.601	0.538	0.108	0.718	1.270	1.703	0.060	5.00	2.12	3	C-8-3-ROUGH-X6	C-8-3-ROUGH-X6A	400409	400403
1.163	0.920	0.787	0.664	0.601	0.108	0.850	1.500	1.875	0.060	5.00	2.12	3	C-10-3-ROUGH-X6	C-10-3-ROUGH-X6A	400389	400391
1.475	1.124	0.950	0.913	0.851	0.138	1.375	2.275	2.725	0.075	6.25	2.25	4	C-12-3-ROUGH-X8	C-12-3-ROUGH-X8A	400328	400330
1.725	1.376	1.209	1.102	1.039	0.138	1.344	2.469	2.968	0.110	6.25	2.12	4	C-16-3-ROUGH-X8	C-16-3-ROUGH-X8A	400340	400342

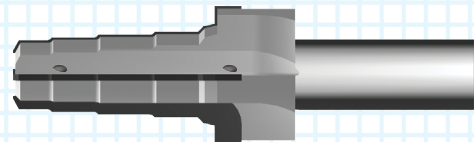
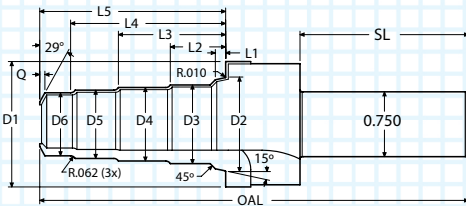

Coolant Hole(s) Each Flute

### FOUR WAY CAVITY

D1	D2	D3	D4	D5	D6	L1	L2	L3	L4	L5	Q	OAL	SL	FLUTES	ORDER #		EDP #	
															UNCOATED	ALTiN+	UNCOATED	ALTiN+
1.163	0.789	0.663	0.601	0.538	0.476	0.108	0.718	1.270	1.830	2.210	0.050	5.50	2.12	3	C-8-4-ROUGH-X6	C-8-4-ROUGH-X6A	400400	400406
1.163	0.920	0.787	0.726	0.664	0.601	0.108	0.872	1.500	2.125	2.500	0.060	5.50	2.12	3	C-10-4-ROUGH-X6	C-10-4-ROUGH-X6A	400393	400395
1.475	1.124	0.950	0.913	0.851	0.788	0.138	1.375	2.275	3.175	3.625	0.075	7.00	2.25	4	C-12-4-ROUGH-X8	C-12-4-ROUGH-X8A	400332	400334
1.725	1.376	1.209	1.102	1.039	0.977	0.138	1.344	2.469	3.594	4.094	0.110	7.25	2.25	4	C-16-4-ROUGH-X8	C-16-4-ROUGH-X8A	400344	400346

THREAD MILLS

SINGLE POINT

INDEXABLE TOOLS

Cavity Tools

SPECIALTY

# EATON VICKERS CAVITY TOOLS

## FINISHERS - CARBIDE TIPPED

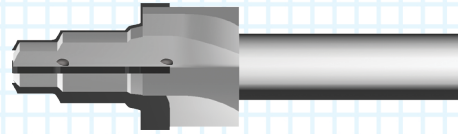
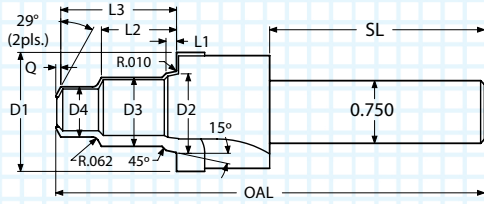

Coolant Hole(s) Each Flute

### TWO WAY CAVITY

D1	D2	D3	D4	L1	L2	L3	Q	OAL	SL	FLUTES	ORDER #		EDP #	
											UNCOATED	ALTiN+	UNCOATED	ALTiN+
1.188	0.814	0.688	0.501	0.108	0.750	1.188	0.050	4.00	2.00	3	C-8-2-FINISH-X6	C-8-2-FINISH-X6A	400373	400375
1.188	0.946	0.812	0.626	0.108	0.934	1.312	0.060	4.00	2.00	3	C-10-2-FINISH-X6	C-10-2-FINISH-X6A	400361	400363
1.500	1.149	0.975	0.938	0.138	1.375	1.825	0.075	5.25	2.25	4	C-12-2-FINISH-X8	C-12-2-FINISH-X8A	400372	400374
1.750	1.401	1.234	1.127	0.138	1.344	1.844	0.075	5.50	2.25	4	C-16-2-FINISH-X8	C-16-2-FINISH-X8A	400384	400386

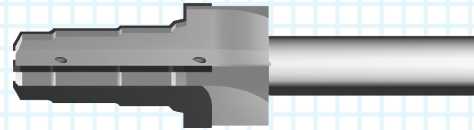
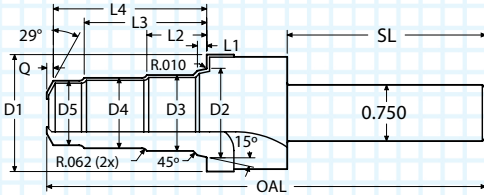

Coolant Hole(s) Each Flute

### THREE WAY CAVITY

D1	D2	D3	D4	D5	L1	L2	L3	L4	Q	OAL	SL	FLUTES	ORDER #		EDP #	
													UNCOATED	ALTiN+	UNCOATED	ALTiN+
1.188	0.814	0.688	0.626	0.563	0.108	0.718	1.270	1.703	0.060	5.00	2.12	3	C-8-3-FINISH-X6	C-8-3-FINISH-X6A	400377	400379
1.188	0.945	0.812	0.689	0.626	0.108	0.850	1.500	1.875	0.060	5.00	2.12	3	C-10-3-FINISH-X6	C-10-3-FINISH-X6A	400365	400367
1.500	1.149	0.975	0.938	0.876	0.138	1.375	2.275	2.725	0.075	6.25	2.25	4	C-12-3-FINISH-X8	C-12-3-FINISH-X8A	400376	400378
1.750	1.401	1.234	1.127	1.064	0.138	1.344	2.469	2.968	0.110	6.25	2.12	4	C-16-3-FINISH-X8	C-16-3-FINISH-X8A	400388	400390

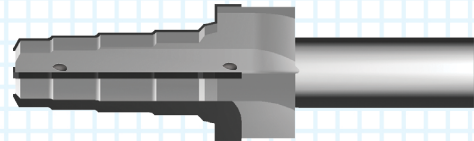
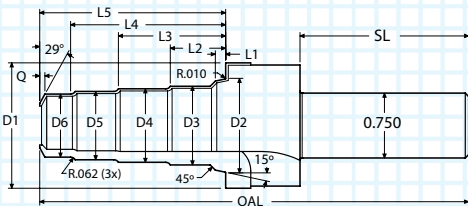

Coolant Hole(s) Each Flute

### FOUR WAY CAVITY

D1	D2	D3	D4	D5	D6	L1	L2	L3	L4	L5	Q	OAL	SL	FLUTES	ORDER #		EDP #	
															UNCOATED	ALTiN+	UNCOATED	ALTiN+
1.188	0.814	0.688	0.626	0.563	0.501	0.108	0.718	1.270	1.830	2.210	0.050	5.50	2.12	3	C-8-4-FINISH-X6	C-8-4-FINISH-X6A	400381	400383
1.188	0.945	0.812	0.751	0.689	0.626	0.108	0.872	1.500	2.125	2.500	0.060	5.50	2.12	3	C-10-4-FINISH-X6	C-10-4-FINISH-X6A	400369	400371
1.500	1.149	0.975	0.938	0.876	0.813	0.138	1.375	2.275	3.175	3.625	0.075	7.00	2.25	4	C-12-4-FINISH-X8	C-12-4-FINISH-X8A	400380	400382
1.750	1.401	1.234	1.127	1.064	1.002	0.138	1.344	2.469	3.594	4.094	0.110	7.25	2.25	4	C-16-4-FINISH-X8	C-16-4-FINISH-X8A	400392	400394

THREAD MILLS

SINGLE POINT

INDEXABLE TOOLS

Cavity Tools

SPECIALTY