

MS33514 (AS33514) - PORT TOOL CARBIDE

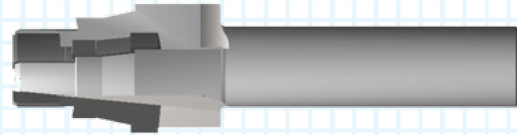
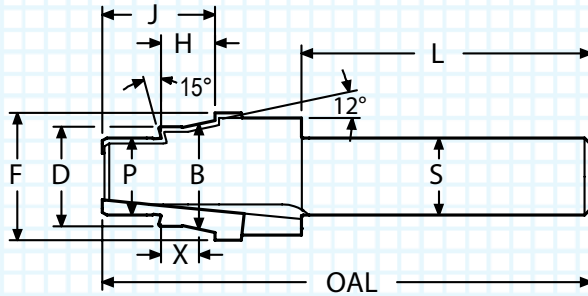

- Meets the requirements of the MS33515
- Precision ground for maximum concentricity
- ALTiN+ coating for higher cutting speed
- Polished flute face for optimum performance
- Meets the requirements of MS33515, AS33515, AS4375, NAS-1214, and NAS1215

B	D	F	H	J	P	X	L	S	OAL	FLUTES	TUBE	THREAD	ORDER #		
													UNCOATED	ALTiN+	
														Solid Carbide	
0.163	0.137	0.300	0.188	0.380	0.091	0.128	2.00	0.375	3.00	3	0.125	0.3125-24 UNJF-3A	MS33514-2	MS33514-2A	
0.234	0.198	0.375	0.234	0.460	0.123	0.158	2.00	0.375	3.00	3	0.188	0.3750-24 UNJF-3A	MS33514-3	MS33514-3A	
0.293	0.263	0.415	0.234	0.460	0.185	0.174	2.00	0.500	3.00	3	0.250	0.4375-20 UNJF-3A	MS33514-4	MS33514-4A	
0.356	0.326	0.475	0.250	0.480	0.232	0.190	2.00	0.500	3.00	3	0.312	0.5000-20 UNJF-3A	MS33514-5	MS33514-5A	
0.416	0.388	0.530	0.250	0.480	0.295	0.193	2.00	0.500	3.00	3	0.375	0.5625-18 UNJF-3A	MS33514-6	MS33514-6A	
														Carbide Tipped	
0.560	0.516	0.690	0.305	0.675	0.420	0.210	1.88	0.500	3.00	3	0.500	0.7500-16 UNJF-3A	MS33514-8	MS33514-8A	
0.686	0.643	0.825	0.350	0.725	0.498	0.255	1.88	0.500	3.15	3	0.625	0.8750-14 UNJF-3A	MS33514-10	MS33514-10A	
0.810	0.768	1.000	0.350	0.775	0.654	0.253	1.88	0.500	3.23	3	0.750	1.0625-12 UNJ-3A	MS33514-12	MS33514-12A	
1.062	1.018	1.250	0.415	0.915	0.873	0.322	2.00	0.750	3.50	4	1.000	1.3125-12 UNJ-3A	MS33514-16	MS33514-16A	
1.316	1.272	1.560	0.415	0.925	1.091	0.325	2.00	0.750	3.62	4	1.250	1.6250-12 UNJ-3A	MS33514-20	MS33514-20A	
1.565	1.522	1.800	0.485	0.925	1.342	0.390	2.12	1.000	3.82	4	1.500	1.8750-12 UNJ-3A	MS33514-24	MS33514-24A	
2.068	2.024	2.400	0.485	0.925	1.811	0.395	2.25	1.000	4.09	4	2.000	2.5000-12 UNJ-3A	MS33514-32	MS33514-32A	

Thread mills available. See page 16.

