

MS33649 (AS5202) - SOLID PILOT PORT TOOL CARBIDE TIPPED

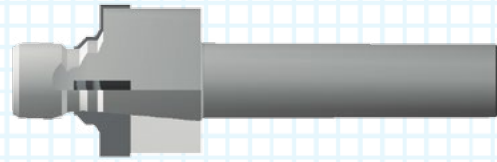
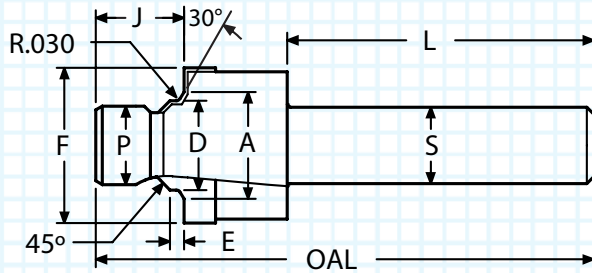

- Ideal for non-standard minor diameter lengths
- Polished flute face for optimum performance
- ALTiN+ coating for improved surface finish
- This port requires a UNJ thread which will specify a larger minor-thread diameter

A	D	E	F	J	P	L	S	OAL	FLUTES	TUBE	THREAD	ORDER #	
												UNCOATED	ALTiN+
0.367	0.2665	0.071	0.575	0.345	0.217	2.00	0.500	3.00	3	N/A	0.2500-28 UNJF-3B	MS33649-1S	MS33649-1SA
0.446	0.3305	0.071	0.742	0.365	0.274	2.00	0.500	3.00	3	0.125	0.3125-24 UNJF-3B	MS33649-2S	MS33649-2SA
0.508	0.3925	0.071	0.805	0.415	0.337	2.00	0.500	3.00	3	0.188	0.3750-24 UNJF-3B	MS33649-3S	MS33649-3SA
0.570	0.4565	0.083	0.888	0.445	0.392	2.00	0.500	3.12	4	0.250	0.4375-20 UNJF-3B	MS33649-4S	MS33649-4SA
0.633	0.5195	0.083	0.950	0.465	0.454	2.00	0.500	3.12	4	0.312	0.5000-20 UNJF-3B	MS33649-5S	MS33649-5SA
0.696	0.5825	0.091	1.012	0.495	0.511	2.00	0.500	3.25	4	0.375	0.5625-18 UNJF-3B	MS33649-6S	MS33649-6SA
0.758	0.6455	0.102	1.105	0.495	0.574	2.00	0.500	3.25	4	0.438	0.6250-18 UNJF-3B	MS33649-7S	MS33649-7SA
0.883	0.7715	0.102	1.240	0.560	0.692	2.12	0.750	3.57	4	0.500	0.7500-16 UNJF-3B	MS33649-8S	MS33649-8SA
0.946	0.8345	0.115	1.300	0.590	0.755	2.12	0.750	3.61	4	0.562	0.8125-16 UNJ-3B	MS33649-9S	MS33649-9SA
1.008	0.8985	0.115	1.415	0.610	0.809	2.12	0.750	3.66	4	0.625	0.8750-14 UNJF-3B	MS33649-10S	MS33649-10SA
1.164	1.0255	0.133	1.602	0.640	0.923	2.12	0.750	3.75	4	0.688	1.0000-12 UNJF-3B	MS33649-11S	MS33649-11SA
1.242	1.0885	0.133	1.665	0.640	0.983	2.12	0.750	3.75	4	0.750	1.0625-12 UNJ-3B	MS33649-12S	MS33649-12SA
1.370	1.2135	0.133	1.790	0.710	1.110	2.25	1.000	4.00	4	0.875	1.1875-12 UNJ-3B	MS33649-14S	MS33649-14SA
1.495	1.3385	0.133	1.965	0.710	1.233	2.25	1.000	4.05	4	1.000	1.3125-12 UNJ-3B	MS33649-16S	MS33649-16SA
1.808	1.6505	0.133	2.310	0.750	1.547	2.25	1.000	4.20	4	1.250	1.6250-12 UNJ-3B	MS33649-20S	MS33649-20SA
2.058	1.9005	0.133	2.628	0.750	1.797	2.25	1.000	4.20	4	1.500	1.8750-12 UNJ-3B	MS33649-24S	MS33649-24SA
2.433	2.2755	0.133	3.050	0.800	2.172	2.25	1.250	4.50	4	1.750	2.2500-12 UNJ-3B	MS33649-28S	MS33649-28SA
2.683	2.5265	0.133	3.520	0.800	2.422	2.50	1.250	4.60	4	2.000	2.5000-12 UNJ-3B	MS33649-32S	MS33649-32SA

Thread mills available. See pages 9-19.

