

HYDRAFORCE CARTRIDGE VALVE TOOLS ROUGHER - CARBIDE TIPPED

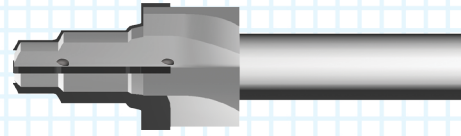
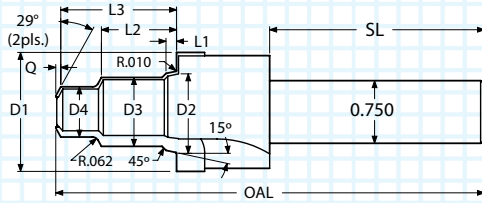

Coolant Hole(s) Each Flute

TWO WAY CAVITY

D1	D2	D3	D4	L1	L2	L3	Q	OAL	SL	FLUTES	ORDER #		EDP #	
											UNCOATED	ALTiN+	UNCOATED	ALTiN+
1.163	0.788	0.663	0.476	0.108	0.750	1.156	0.045	4.00	2.00	3	VC08-2-ROUGH-X6	VC08-2-ROUGH-X6A	400902	400917
1.163	0.920	0.787	0.601	0.108	0.932	1.312	0.060	4.00	2.25	3	VC10-2-ROUGH-X6	VC10-2-ROUGH-X6A	400903	400935
1.475	1.125	0.952	0.851	0.138	1.400	1.920	0.075	5.25	2.25	4	VC12-2-ROUGH-X8	VC12-2-ROUGH-X8A	400919	400969
1.725	1.376	1.209	1.102	0.138	1.344	1.844	0.075	5.50	2.25	4	VC16-2-ROUGH-X8	VC16-2-ROUGH-X8A	400928	400978

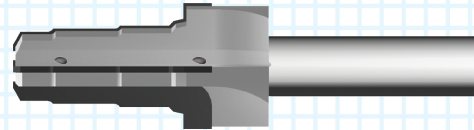
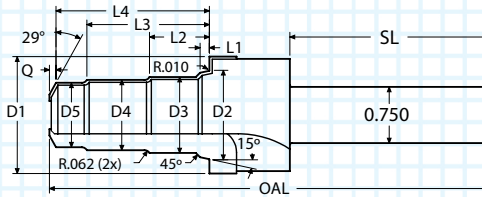

Coolant Hole(s) Each Flute

THREE WAY CAVITY - COOLANT THROUGH

D1	D2	D3	D4	L1	L2	L3	Q	OAL	SL	FLUTES	ORDER #		EDP #	
											UNCOATED	ALTiN+	UNCOATED	ALTiN+
1.163	0.788	0.663	0.476	0.108	0.750	1.270	0.060	5.00	2.12	3	VC08-3-ROUGH-X6	VC08-3-ROUGH-X6A	400905	400923
1.163	0.920	0.787	0.601	0.108	0.860	1.500	0.050	5.00	2.12	3	VC10-3-ROUGH-X6	VC10-3-ROUGH-X6A	400941	400944
1.475	1.125	0.952	0.851	0.138	1.400	2.370	0.070	6.25	2.12	4	VC12-3-ROUGH-X8	VC12-3-ROUGH-X8A	400922	400972
1.725	1.376	1.209	1.102	0.138	1.344	2.469	0.065	6.25	2.12	4	VC16-3-ROUGH-X8	VC16-3-ROUGH-X8A	400931	400981

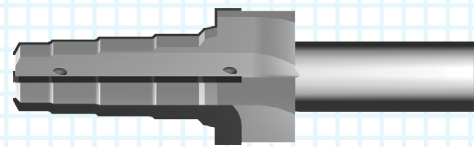
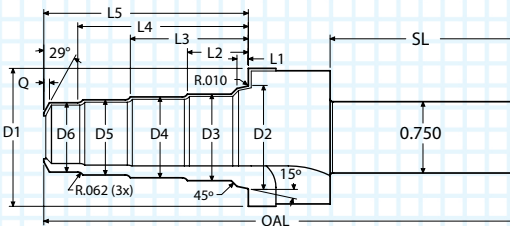

Coolant Hole(s) Each Flute

FOUR WAY CAVITY - COOLANT THROUGH

D1	D2	D3	D4	L1	L2	L3	Q	OAL	SL	FLUTES	ORDER #		EDP #	
											UNCOATED	ALTiN+	UNCOATED	ALTiN+
1.163	0.788	0.663	0.601	0.538	0.718	1.270	0.050	5.50	2.12	3	VC08-4-ROUGH-X6	VC08-4-ROUGH-X6A	400924	400929
1.163	0.920	0.787	0.726	0.664	0.870	1.500	0.045	5.50	2.12	3	VC10-4-ROUGH-X6	VC10-4-ROUGH-X6A	400950	400909
1.475	1.125	0.950	0.913	0.851	1.400	3.860	0.070	7.00	2.25	4	VC12-4-ROUGH-X8	VC12-4-ROUGH-X8A	400925	400975
1.725	1.376	1.209	1.102	1.039	1.344	4.094	0.070	7.25	2.25	4	VC16-4-ROUGH-X8	VC16-4-ROUGH-X8A	400934	400984

THREAD MILLS

SINGLE POINT

INDEXABLE TOOLS

Cavity Tools

SPECIALTY

HYDRAFORCE CARTRIDGE VALVE TOOLS

FINISHER - CARBIDE TIPPED

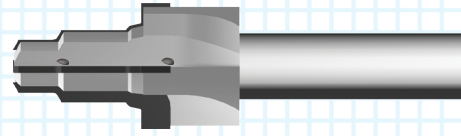
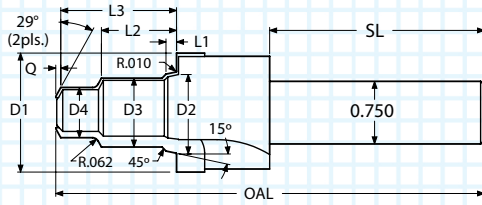

Coolant Hole(s) Each Flute

TWO WAY CAVITY - COOLANT THROUGH

D1	D2	D3	D4	L1	L2	L3	Q	OAL	SL	FLUTES	ORDER #		EDP #	
											UNCOATED	ALTIN+	UNCOATED	ALTIN+
1.188	0.813	0.688	0.501	0.108	0.750	1.156	0.050	4.00	2.00	3	VC08-2-FINISH-X6	VC08-2-FINISH-X6A	400914	400915
1.188	0.945	0.812	0.626	0.108	0.932	1.312	0.060	4.00	2.00	3	VC10-2-FINISH-X6	VC10-2-FINISH-X6A	400932	400906
1.500	1.150	0.977	0.876	0.138	1.400	1.920	0.075	5.25	2.25	4	VC12-2-FINISH-X8	VC12-2-FINISH-X8A	400579	400618
1.750	1.401	1.234	1.127	0.138	1.344	1.844	0.075	5.50	2.25	4	VC16-2-FINISH-X8	VC16-2-FINISH-X8A	400588	400627

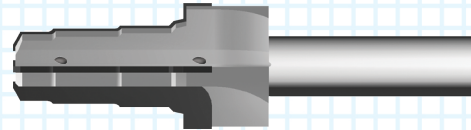
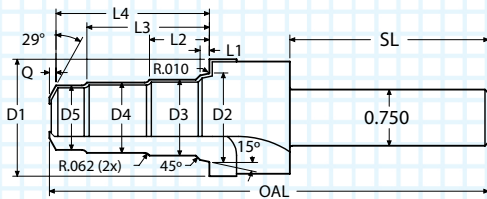

Coolant Hole(s) Each Flute

THREE WAY CAVITY - COOLANT THROUGH

D1	D2	D3	D4	D5	L1	L2	L3	L4	Q	OAL	SL	FLUTES	ORDER #		EDP #	
													UNCOATED	ALTIN+	UNCOATED	ALTIN+
1.188	0.813	0.688	0.626	0.563	0.108	0.718	1.270	1.703	0.060	5.00	2.12	3	VC08-3-FINISH-X6	VC08-3-FINISH-X6A	400920	400918
1.188	0.945	0.812	0.689	0.626	0.108	0.860	1.500	1.875	0.050	5.00	2.12	3	VC10-3-FINISH-X6	VC10-3-FINISH-X6A	400938	400908
1.500	1.150	0.975	0.938	0.876	0.138	1.400	2.370	2.890	0.070	6.25	2.12	4	VC12-3-FINISH-X8	VC12-3-FINISH-X8A	400582	400621
1.750	1.401	1.234	1.127	1.064	0.138	1.344	2.469	2.968	0.065	6.25	2.12	4	VC16-3-FINISH-X8	VC16-3-FINISH-X8A	400591	400630

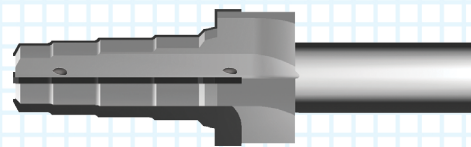
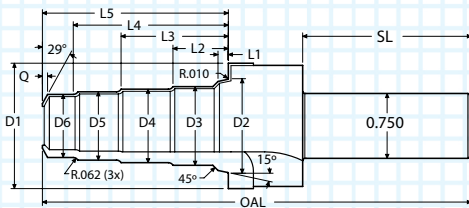

Coolant Hole(s) Each Flute

FOUR WAY CAVITY - COOLANT THROUGH

D1	D2	D3	D4	D5	D6	L1	L2	L3	L4	L5	Q	OAL	SL	FLUTES	ORDER #		EDP #	
															UNCOATED	ALTIN+	UNCOATED	ALTIN+
1.188	0.813	0.688	0.626	0.563	0.501	0.108	0.718	1.270	1.830	2.210	0.050	5.50	2.12	3	VC08-4-FINISH-X6	VC08-4-FINISH-X6A	400926	400921
1.188	0.945	0.812	0.751	0.689	0.626	0.108	0.870	1.500	2.125	2.500	0.055	5.50	2.12	3	VC10-4-FINISH-X6	VC10-4-FINISH-X6A	400927	400947
1.500	1.150	0.975	0.938	0.876	0.813	0.138	1.400	2.370	3.330	3.860	0.070	7.00	2.25	4	VC12-4-FINISH-X8	VC12-4-FINISH-X8A	400585	400624
1.750	1.401	1.234	1.127	1.064	1.002	0.138	1.344	2.469	3.594	4.094	0.070	7.25	2.25	4	VC16-4-FINISH-X8	VC16-4-FINISH-X8A	400594	400633

THREAD MILLS

SINGLE POINT

INDEXABLE TOOLS

Cavity Tools

SPECIALTY