

# PARKER STANDARD BODIES & CAVITIES

## FINISHER - CARBIDE TIPPED

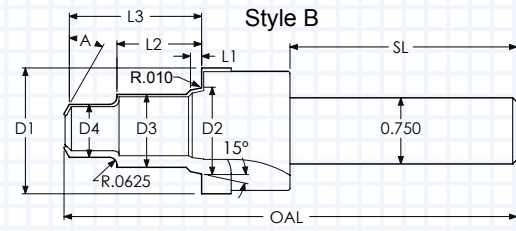
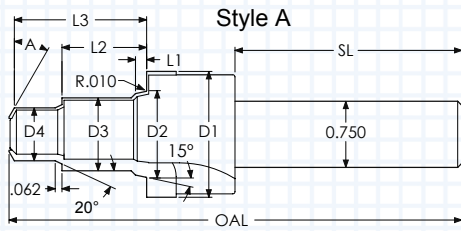

### TWO WAY CAVITY

D1	D2	D3	D4	L1	L2	L3	A	OAL	SL	FLUTES	STYLE	ORDER #		EDP #	
												UNCOATED	ALTiN+	UNCOATED	ALTiN+
1.188	0.814	0.688	0.501	0.108	0.750	1.125	30°	4.00	2.00	3	B	SBC08-2-FINISH-X6	SBC08-2-FINISH-X6A	400402	400405
1.188	0.945	0.812	0.626	0.108	0.937	1.312	30°	4.00	2.00	3	B	SBC10-2-FINISH-X6	SBC10-2-FINISH-X6A	400420	400423
1.625	1.150	0.976	0.876	0.138	1.182	1.658	30°	5.25	2.25	4	A	SBC12-2-FINISH-X8	SBC12-2-FINISH-X8A	400278	400290
1.750	1.401	1.234	1.127	0.138	1.344	1.844	30°	5.50	2.25	4	B	SBC16-2-FINISH-X8	SBC16-2-FINISH-X8A	400281	400293

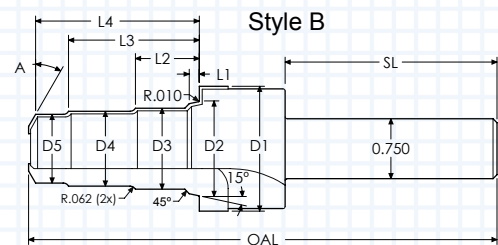
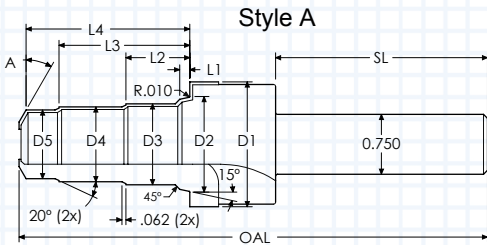

### THREE WAY CAVITY

D1	D2	D3	D4	D5	L1	L2	L3	L4	A	OAL	SL	FLUTES	STYLE	ORDER #		EDP #	
														UNCOATED	ALTiN+	UNCOATED	ALTiN+
1.188	0.814	0.688	0.626	0.563	0.108	0.680	1.240	1.719	31°	5.00	2.12	3	B	SBC08-3-FINISH-X6	SBC08-3-FINISH-X6A	400408	400411
1.188	0.945	0.812	0.689	0.626	0.108	0.850	1.500	1.875	30°	5.00	2.12	3	B	SBC10-3-FINISH-X6	SBC10-3-FINISH-X6A	400426	400429
1.625	1.150	0.975	0.938	0.876	0.138	1.062	1.908	2.326	30°	5.75	2.25	4	A	SBC12-3-FINISH-X8	SBC12-3-FINISH-X8A	400279	400291
1.750	1.401	1.234	1.127	1.064	0.138	1.344	2.469	2.968	30°	6.25	2.12	4	B	SBC16-3-FINISH-X8	SBC16-3-FINISH-X8A	400282	400294

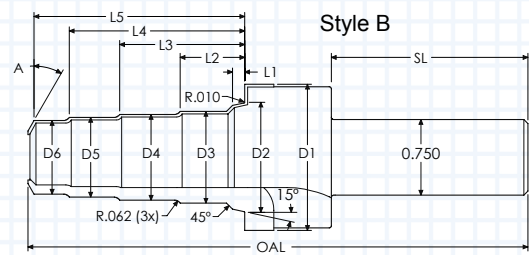
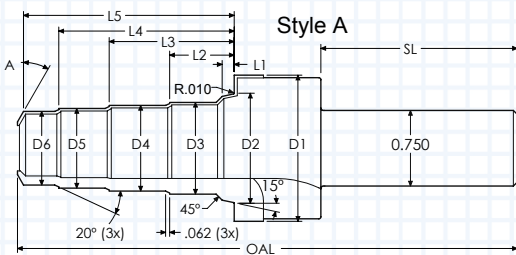

### FOUR WAY CAVITY

D1	D2	D3	D4	D5	D6	L1	L2	L3	L4	L5	A	OAL	SL	FLUTES	STYLE	ORDER #		EDP #	
																UNCOATED	ALTiN+	UNCOATED	ALTiN+
1.188	0.814	0.688	0.626	0.563	0.501	0.108	0.680	1.240	1.797	2.125	31°	5.50	2.12	3	B	SBC08-4-FINISH-X6	SBC08-4-FINISH-X6A	400414	400417
1.188	0.945	0.812	0.751	0.689	0.626	0.108	0.875	1.500	2.125	2.500	31°	5.50	2.12	3	B	SBC10-4-FINISH-X6	SBC10-4-FINISH-X6A	400432	400435
1.625	1.150	0.975	0.938	0.876	0.814	0.138	1.062	1.908	2.758	3.176	30°	6.50	2.25	4	A	SBC12-4-FINISH-X8	SBC12-4-FINISH-X8A	400280	400292
1.750	1.401	1.234	1.127	1.064	1.002	0.138	1.344	2.469	3.594	4.094	30°	7.25	2.25	4	A	SBC16-4-FINISH-X8	SBC16-4-FINISH-X8A	400295	400296

# PARKER STANDARD BODIES & CAVITIES

## ROUGHER - CARBIDE TIPPED

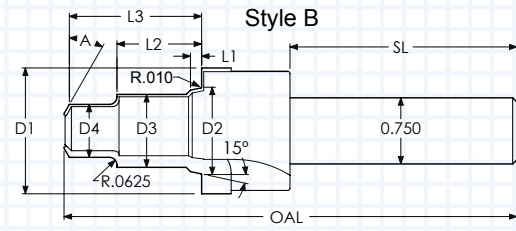
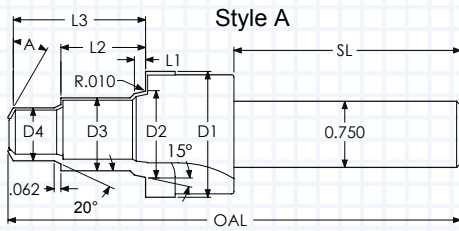

### TWO WAY CAVITY

D1	D2	D3	D4	L1	L2	L3	A	OAL	SL	FLUTES	STYLE	ORDER #		EDP #	
												UNCOATED	ALTiN+	UNCOATED	ALTiN+
1.170	0.794	0.668	0.481	0.108	0.750	1.125	30°	4.00	2.00	3	B	SBC08-2-ROUGH-X6	SBC08-2-ROUGH-X6A	400160	400161
1.170	0.925	0.792	0.606	0.108	0.937	1.312	30°	4.00	2.00	3	B	SBC10-2-ROUGH-X6	SBC10-2-ROUGH-X6A	400166	400167
1.606	1.131	0.956	0.856	0.138	1.182	1.658	30°	5.25	2.25	4	A	SBC12-2-ROUGH-X8	SBC12-2-ROUGH-X8A	400172	400173
1.730	1.381	1.214	1.107	0.138	1.344	1.844	30°	5.50	2.25	4	B	SBC16-2-ROUGH-X8	SBC16-2-ROUGH-X8A	400178	400179

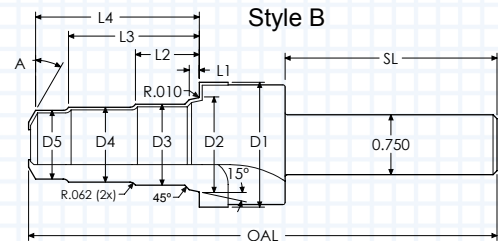
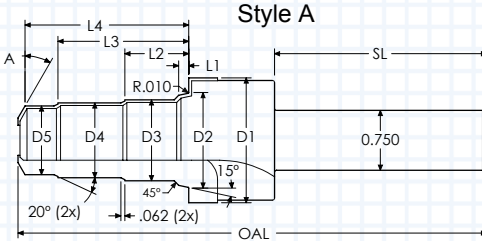

### THREE WAY CAVITY

D1	D2	D3	D4	D5	L1	L2	L3	L4	A	OAL	SL	FLUTES	STYLE	ORDER #		EDP #	
														UNCOATED	ALTiN+	UNCOATED	ALTiN+
1.170	0.794	0.668	0.606	0.543	0.108	0.680	1.240	1.719	31°	5.00	2.12	3	B	SBC08-3-ROUGH-X6	SBC08-3-ROUGH-X6A	400162	400163
1.170	0.925	0.792	0.669	0.606	0.108	0.850	1.500	1.875	30°	5.00	2.12	3	B	SBC10-3-ROUGH-X6	SBC10-3-ROUGH-X6A	400168	400169
1.606	1.131	0.955	0.918	0.856	0.138	1.062	1.908	2.326	30°	5.75	2.25	4	A	SBC12-3-ROUGH-X8	SBC12-3-ROUGH-X8A	400174	400175
1.730	1.381	1.214	1.107	1.044	0.138	1.344	2.469	2.968	30°	6.25	2.12	4	B	SBC16-3-ROUGH-X8	SBC16-3-ROUGH-X8A	400180	400181

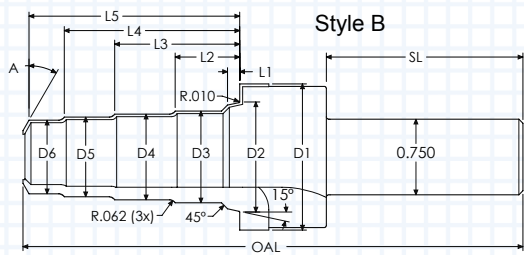
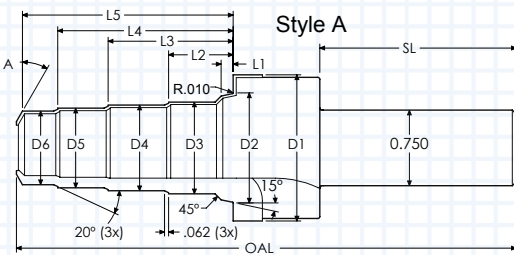

### FOUR WAY CAVITY

D1	D2	D3	D4	D5	D6	L1	L2	L3	L4	L5	A	OAL	SL	FLUTES	STYLE	ORDER #		EDP #	
																UNCOATED	ALTiN+	UNCOATED	ALTiN+
1.170	0.794	0.668	0.606	0.543	0.481	0.108	0.680	1.240	1.797	2.125	31°	5.50	2.12	3	B	SBC08-4-ROUGH-X6	SBC08-4-ROUGH-X6A	400164	400165
1.170	0.925	0.792	0.731	0.669	0.606	0.108	0.875	1.500	2.125	2.500	31°	5.50	2.12	3	B	SBC10-4-ROUGH-X6	SBC10-4-ROUGH-X6A	400170	400171
1.606	1.131	0.955	0.918	0.856	0.794	0.138	1.062	1.908	2.758	3.176	30°	6.50	2.25	4	A	SBC12-4-ROUGH-X8	SBC12-4-ROUGH-X8A	400176	400177
1.730	1.381	1.214	1.107	1.044	0.982	0.138	1.344	2.469	3.594	4.094	30°	7.25	2.25	4	A	SBC16-4-ROUGH-X8	SBC16-4-ROUGH-X8A	400182	400183