

# HYDRAFORCE CARTRIDGE VALVE TOOLS

## ROUGHER - CARBIDE TIPPED

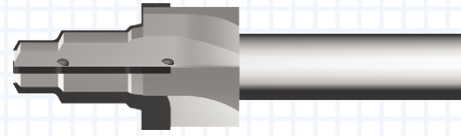
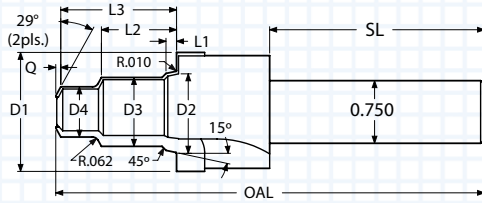

Coolant Hole(s) Each Flute

### TWO WAY CAVITY

D1	D2	D3	D4	L1	L2	L3	Q	OAL	SL	ORDER #		EDP #	
										UNCOATED	ALTiN+	UNCOATED	ALTiN+
1.163	0.788	0.663	0.476	0.108	0.750	1.156	0.045	4.00	2.00	VC08-2-ROUGH-X8	VC08-2-ROUGH-X8A	400901	400951
1.163	0.920	0.787	0.601	0.108	0.932	1.312	0.060	4.00	2.25	VC10-2-ROUGH-X8	VC10-2-ROUGH-X8A	400910	400960
1.475	1.125	0.952	0.851	0.138	1.400	1.920	0.075	5.25	2.25	VC12-2-ROUGH-X8	VC12-2-ROUGH-X8A	400919	400969
1.725	1.376	1.209	1.102	0.138	1.344	1.844	0.075	5.50	2.25	VC16-2-ROUGH-X8	VC16-2-ROUGH-X8A	400928	400978

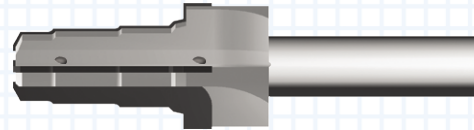
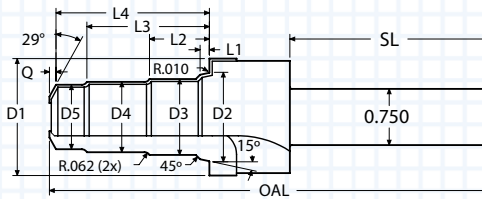

Coolant Hole(s) Each Flute

### THREE WAY CAVITY - COOLANT THROUGH

D1	D2	D3	D4	L1	L2	L3	Q	OAL	SL	ORDER #		EDP #	
										UNCOATED	ALTiN+	UNCOATED	ALTiN+
1.163	0.788	0.663	0.476	0.108	0.750	1.270	0.060	5.00	2.12	VC08-3-ROUGH-X8	VC08-3-ROUGH-X8A	400904	400954
1.163	0.920	0.787	0.601	0.108	0.860	1.500	0.050	5.00	2.12	VC10-3-ROUGH-X8	VC10-3-ROUGH-X8A	400913	400963
1.475	1.125	0.952	0.851	0.138	1.400	2.370	0.070	6.25	2.12	VC12-3-ROUGH-X8	VC12-3-ROUGH-X8A	400922	400972
1.725	1.376	1.209	1.102	0.138	1.344	2.469	0.065	6.25	2.12	VC16-3-ROUGH-X8	VC16-3-ROUGH-X8A	400931	400981

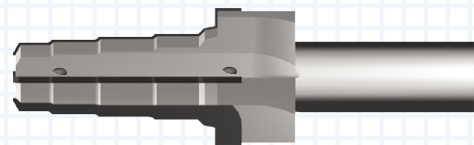
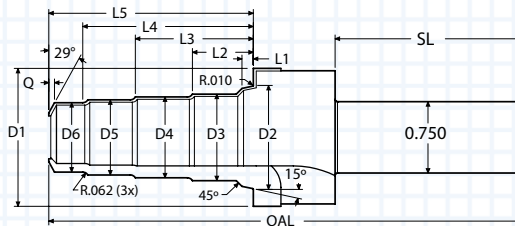

Coolant Hole(s) Each Flute

### FOUR WAY CAVITY - COOLANT THROUGH

D1	D2	D3	D4	L1	L2	L3	Q	OAL	SL	ORDER #		EDP #	
										UNCOATED	ALTiN+	UNCOATED	ALTiN+
1.163	0.788	0.663	0.601	0.538	0.718	1.270	0.050	5.50	2.12	VC08-4-ROUGH-X8	VC08-4-ROUGH-X8A	400907	400957
1.163	0.920	0.787	0.726	0.664	0.870	1.500	0.045	5.50	2.12	VC10-4-ROUGH-X8	VC10-4-ROUGH-X8A	400916	400966
1.475	1.125	0.950	0.913	0.851	1.400	3.860	0.070	7.00	2.25	VC12-4-ROUGH-X8	VC12-4-ROUGH-X8A	400925	400975
1.725	1.376	1.209	1.102	1.039	1.344	4.094	0.070	7.25	2.25	VC16-4-ROUGH-X8	VC16-4-ROUGH-X8A	400934	400984

THREAD MILLS

SINGLE POINT

INDEXABLE TOOLS

Cavity Tools

SPECIALTY

# HYDRAFORCE CARTRIDGE VALVE TOOLS

## FINISHER - CARBIDE TIPPED

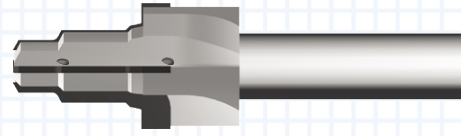
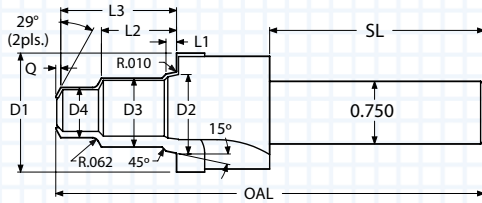

Coolant Hole(s) Each Flute

### TWO WAY CAVITY - COOLANT THROUGH

D1	D2	D3	D4	L1	L2	L3	Q	OAL	SL	ORDER #		EDP #	
										UNCOATED	ALTIN+	UNCOATED	ALTIN+
1.188	0.813	0.688	0.501	0.108	0.750	1.156	0.050	4.00	2.00	VC08-2-FINISH-X8	VC08-2-FINISH-X8A	400561	400600
1.188	0.945	0.812	0.626	0.108	0.932	1.312	0.060	4.00	2.00	VC10-2-FINISH-X8	VC10-2-FINISH-X8A	400570	400609
1.500	1.150	0.977	0.876	0.138	1.400	1.920	0.075	5.25	2.25	VC12-2-FINISH-X8	VC12-2-FINISH-X8A	400579	400618
1.750	1.401	1.234	1.127	0.138	1.344	1.844	0.075	5.50	2.25	VC16-2-FINISH-X8	VC16-2-FINISH-X8A	400588	400627

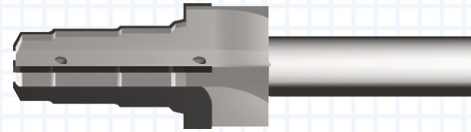
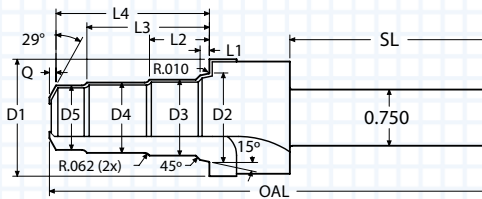

Coolant Hole(s) Each Flute

### THREE WAY CAVITY - COOLANT THROUGH

D1	D2	D3	D4	D5	L1	L2	L3	L4	Q	OAL	SL	ORDER #		EDP #	
												UNCOATED	ALTIN+	UNCOATED	ALTIN+
1.188	0.813	0.688	0.626	0.563	0.108	0.718	1.270	1.703	0.060	5.00	2.12	VC08-3-FINISH-X8	VC08-3-FINISH-X8A	400564	400603
1.188	0.945	0.812	0.689	0.626	0.108	0.860	1.500	1.875	0.050	5.00	2.12	VC10-3-FINISH-X8	VC10-3-FINISH-X8A	400573	400612
1.500	1.150	0.975	0.938	0.876	0.138	1.400	2.370	2.890	0.070	6.25	2.12	VC12-3-FINISH-X8	VC12-3-FINISH-X8A	400582	400621
1.750	1.401	1.234	1.127	1.064	0.138	1.344	2.469	2.968	0.065	6.25	2.12	VC16-3-FINISH-X8	VC16-3-FINISH-X8A	400591	400630

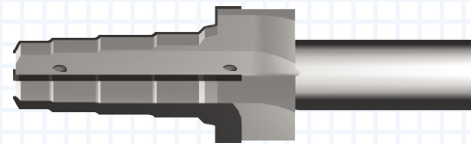
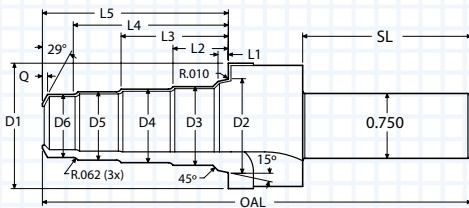

Coolant Hole(s) Each Flute

### FOUR WAY CAVITY - COOLANT THROUGH

D1	D2	D3	D4	D5	D6	L1	L2	L3	L4	L5	Q	OAL	SL	ORDER #		EDP #	
														UNCOATED	ALTIN+	UNCOATED	ALTIN+
1.188	0.813	0.688	0.626	0.563	0.501	0.108	0.718	1.270	1.830	2.210	0.050	5.50	2.12	VC08-4-FINISH-X8	VC08-4-FINISH-X8A	400567	400606
1.188	0.945	0.812	0.751	0.689	0.626	0.108	0.870	1.500	2.125	2.500	0.055	5.50	2.12	VC10-4-FINISH-X8	VC10-4-FINISH-X8A	400576	400615
1.500	1.150	0.975	0.938	0.876	0.813	0.138	1.400	2.370	3.330	3.860	0.070	7.00	2.25	VC12-4-FINISH-X8	VC12-4-FINISH-X8A	400585	400624
1.750	1.401	1.234	1.127	1.064	1.002	0.138	1.344	2.469	3.594	4.094	0.070	7.25	2.25	VC16-4-FINISH-X8	VC16-4-FINISH-X8A	400594	400633

THREAD MILLS

SINGLE POINT

INDEXABLE TOOLS

Cavity Tools

SPECIALTY

# PORT & CAVITY TECHNICAL INFORMATION

MATERIAL	HB/Rc	SPEED (SFM)		CUTTING CONDITIONS	
		UNCOATED	ALTiN+	INFEEED PER FLUTE REAM	INFEEED PER FLUTE SPOT FACE
CAST IRON	130 HB	75-210	200-450	.001-.0025	.0008-.0020
CARBON STEEL	18 Rc	125-190	190-400	.001-.0030	.001-.0020
ALLOY STEEL	20 Rc	70-135	130-350	.001-.0030	.0008-.0020
TOOL STEEL	25 Rc	75-100	100-220	.001-.0025	.0005-.0020
300 STAINLESS STEEL	150 HB	90-100	100-230	.001-.0020	.0007-.0015
400 STAINLESS STEEL	195 HB	90-135	135-300	.001-.0020	.0005-.0015
HIGH TEMP ALLOY (NICKEL & COBALT BASE)	20 Rc	30-125	100-150	.0008-.0015	.0005-.0010
TITANIUM	25 Rc	50-100	100-140	.001-.0020	.0005-.0010
HEAT TREATED ALLOYS (38-45Rc)	40 Rc	50-75	75-130	.0008-.0015	.0005-.0010
ALUMINUM	100 HB	850-1000	800-1500	.002-.0040	.0010-.0030
BRASS, ZINC	80 HB	750-950	800-1200	.002-.0040	.0010-.0030

SFM = Surface Feet per Minute

RPM = SFM x 3.82 divided by tool diameter

Starting parameters only. Setup and machine rigidity may affect performance.

PROBLEM	CAUSE	SOLUTION
RAPID FLANK WEAR	CUTTING CONDITIONS	Check for excessive speed and feed - see chart.
	TOOL	Select a coated tool.
	PROGRAM	Remove dwell from program at end of cut.
BUILT-UP EDGE	TOOL	Select a coated tool. The coating will resist built-up edges.
	HEAT	Use coolant through port tool. If coolant is not available, use shop air and a coated tool.
SURFACE TORN	TOOL	Use a coated tool. On most carbon steels, an uncoated tool will not produce an acceptable finish.
CHATTER	TOOL	Hone cutting edge of spot face. Use Coated Tool. Increase chip load.
LIGHT CHATTER	PROGRAM	Increase speed by 15-20%. A faster speed reduces forces. A dwell typically will not remove chatter.
POOR TOOL LIFE	AMOUNT OF STOCK	Rough port to 0.97 inch of finish size.
	PART	Make sure prior operation did not work harden the material.

## SAMPLE PROGRAM FOR MAXIMUM PRODUCTIVITY

N51 (Sample Port Tool Program: MS33649-4RA (ALTiN+) cutting Carbon Steel

**T51 M06**

**Select Tool**

**S2916 M03**

**SFM = 300 ; RPM = 300 x 3.82 / Reamer Diameter**

**G00 G90 G54 X0. Y0.**

**RPM = 300 X 3.82 / 0.393**

**G43 H51 Z0.1 M08**

**RPM = 2916**

**G01 Z-0.6 F23.3**

**Feed Rate = RPM x 0.002 x 4 (Number of Flutes)**

**S1290 M03**

**RPM = 300 x 3.82 / 0.888 (Spot Face Diameter)**

**G04 P1.**

**Dwell to slow down spindle**

**G01 Z-.73 F10.3**

**Feed rate = RPM x 0.002 x 4 (Number of Flutes)**

**G00 Z5. M09**