

ISO 1179 - PORT TOOL CARBIDE TIPPED

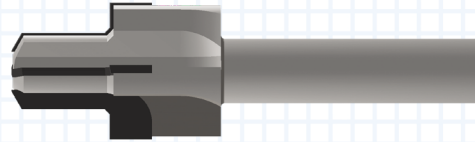
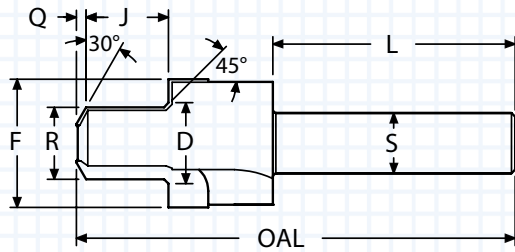

- Meets the requirements of the ISO1179
- Polished flute face for optimum performance
- Precision ground for maximum concentricity
- AlTiN+ coating for improved surface finish

D	F	J	R	Q	L	S	OAL	FLUTES	THREAD	ORDER #		EDP #	
										UNCOATED	ALTiN+	UNCOATED	ALTiN+
0.398	0.681	0.445	0.345	0.045	2.00	0.500	3.50	3	G1/8	1179-G125	1179-G125A	402874	402875
0.524	0.819	0.683	0.459	0.065	2.00	0.500	3.62	3	G1/4	1179-G250	1179-G250A	402876	402877
0.662	0.969	0.683	0.597	0.080	2.00	0.500	3.62	4	G3/8	1179-G375	1179-G375A	402878	402879
0.831	1.169	0.801	0.741	0.090	2.00	0.750	3.62	4	G1/2	1179-G500	1179-G500A	402880	402881
1.048	1.457	0.880	0.958	0.120	2.50	0.750	4.37	4	G3/4	1179-G750	1179-G750A	402882	402883
1.319	1.819	0.998	1.201	0.120	2.50	1.000	4.62	4	G1	1179-G1000	1179-G1000A	402884	402885
1.662	2.130	1.078	1.541	0.125	2.50	1.000	4.62	4	G1-1/4	1179-G1250	1179-G1250A	402886	402887
1.894	2.386	1.200	1.774	0.125	2.50	1.000	4.88	4	G1-1/2	1179-G1500	1179-G1500A	402888	402889

THREAD MILLS

SINGLE POINT

INDEXABLE TOOLS

Port Tools

SPECIALTY